

Industrial/Commercial Property

Available for Lease or Sale



11 Iowa Place

20,000 sq. ft. steel frame, commercial building, pitched roof, loading dock, ample parking/expansion space

- Location: Loring Commerce Centre
Limestone, Maine
- Utilities: water/wastewater—LDA
electricity— Maine Public Service
- Telecommunications: Fiber optics available

- Lease/sale price negotiable

Contact:
Carl Flora, President & CEO
Loring Development Authority of Maine
154 Development Drive, Suite F
Limestone, Maine 04750
cflora@loring.org
Phone (207) 328-7005 ext: 2
Fax (207) 328-6811

11 Iowa Place
19,321 sq. ft.
Steel frame - 18" on center
Roof 12 pitch

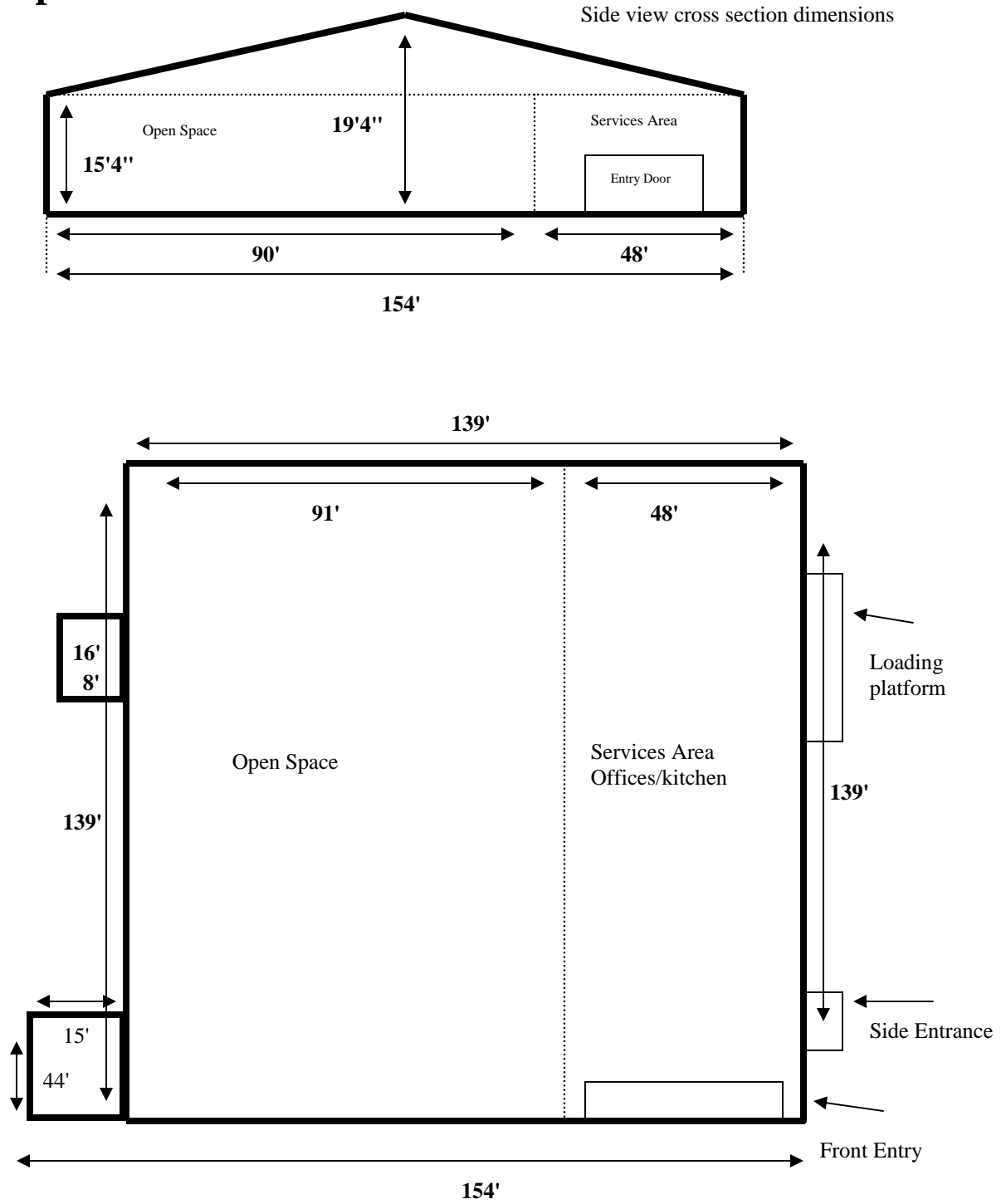

For informational purposes only—not to scale—detailed line drawings available, contact LDA